

Series 10-MS

Stainless Miniature Fittings

RoHS

Construction



Hose nipple

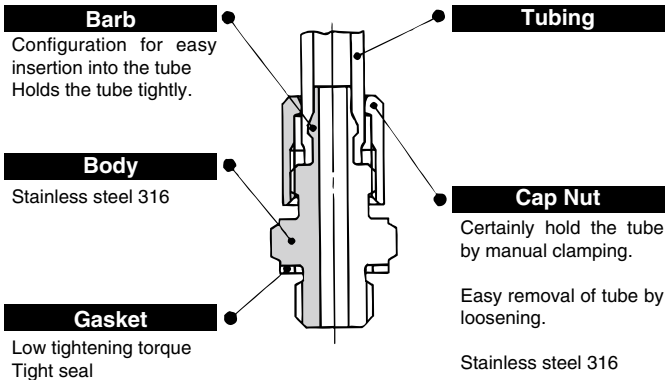

Barb fitting

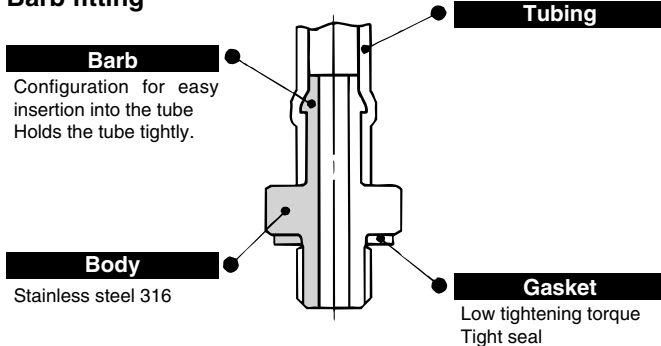













Specifications

Applicable tubing material	Polyurethane	
Applicable tubing diameter	ø3.18/ø2, ø4/ø2.5, ø6/ø4	
Fluid	Air, Water (Note)	
Max. operating pressure (at 20°C)	0.8 MPa	
Ambient and fluid temperature	-5 to 60°C, Water: 0 to 40°C (No freezing)	
Connection size	M5	
Material	Body	Stainless steel 316
	Gasket	PVC, Nylon 66, GF30%
Grease	Fluorine grease (10-MS-5UN only)	
Cleanliness class (ISO class)	Class 3	

Note) Barb fitting, barb elbow and barb tee are not compatible with water.

Model

Model	Description	Application	Note	Model	Description	Application	Note
10-MS-5AU-3	Barb fittings for polyurethane tube	For polyurethane tube	ø3.18/ø2 x M5	10-MS-5UL	Universal elbow	Body rotates at 360° around the stud axis.	M5 female x M5 male
10-MS-5AU-4			ø4/ø2.5 x M5				
10-MS-5AU-6			ø6/ø4 x M5		10-MS-5UT		
10-MS-5ALHU-3	Barb elbow for polyurethane tube	For polyurethane tube Body rotates at 360° around the stud axis.	ø3.18/ø2 x M5	10-MS-5B	Bushing	For reducing R (PT) 1/8 to M5	R1/8 x M5 female
10-MS-5ALHU-4			ø4/ø2.5 x M5				
10-MS-5ALHU-6			ø6/ø4 x M5		10-MS-5P		
10-MS-5H-4	Hose nipple	For polyurethane tube	ø4/ø2.5 x M5	10-MS-5J	Extension fitting	Solid piece moves fitting up from workpiece.	M5 male x M5 female
10-MS-5H-6			ø6/ø4 x M5		10-MS-5N		
10-MS-5HLH-4	Hose elbow	For polyurethane tube Body rotates at 360° around the stud axis.	ø4/ø2.5 x M5	10-MS-5UN	Universal nipple	Body rotates at 360° around the stud axis.	M5 male x M5 male PAT.
10-MS-5HLH-6			ø6/ø4 x M5		10-MS-5ATHU-3		
10-M-5G1	Gasket	To seal M5 thread	Material: PVC	10-MS-5ATHU-4		For polyurethane tube Body rotates at 360° around the stud axis.	ø4/ø2.5 x M5
				10-MS-5ATHU-6			
				10-M-5GH	Gasket (H)	To seal M5 thread	Material: Nylon 66, GF30% only
							

Directional Control Valves

Air Cylinders

Rotary Actuators

Air Grippers

Air Preparation Equipment

Modular F. R.

Pressure Control Equipment

Fittings & Tubing

Flow Control Equipment

Pressure Switches/ Pressure Sensors

Barb Fittings for Polyurethane Tube: 10-MS-5AU-3, -4, -6

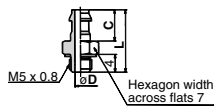

Model	C	D	L	Effective area (mm ²)	Weight (g)
10-MS-5AU-3	4.5	1.6	11.5	1.7	1.4
10-MS-5AU-4	5	1.8	12	2.1	1.5
10-MS-5AU-6	7	2.5	14	4.0	1.7

Barb Elbow for Polyurethane Tube: 10-MS-5ALHU-3, -4, -6

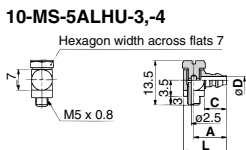

Model	A	C	D	L	Effective area (mm ²)	Weight (g)
10-MS-5ALHU-3	8	4.5	1.6	11.8	1.1	3.0
10-MS-5ALHU-4	8.8	5.0	1.8	12.6	1.4	3.1
10-MS-5ALHU-6	10.8	7.0	2.5	14.6	2.4	3.7

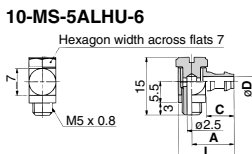

Hose Nipple: 10-MS-5H-4, -6

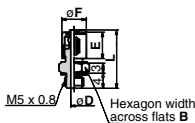

Model	B	D	L	E	F	Effective area (mm ²)	Weight (g)
10-MS-5H-4	7	1.8	15.5	7	6.5	2.1	2.5
10-MS-5H-6	8	2.5	16.5	8	8.5	4.0	3.7

Hose Elbow: 10-MS-5HLH-4, -6

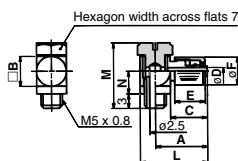

Model	A	B	C	D	E	F	L	M	N	Effective area (mm ²)	Weight (g)
10-MS-5HLH-4	12	7	8.5	1.8	7	6.5	15.8	15	5.5	1.4	4.2
10-MS-5HLH-6	13.5	8	9.5	2.5	8	8.5	17.8	16	6	2.4	6.2

Universal Elbow: 10-MS-5UL

Effective area: 2.4 mm²
Weight: 4.5 g

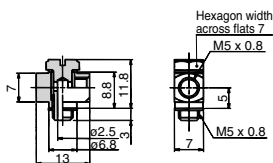

Universal Tee: 10-MS-5UT

Effective area: 2.4 mm²
Weight: 4.5 g

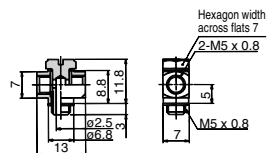

Bushing: 10-MS-5B

Effective area: 12 mm²
Weight: 5.5 g

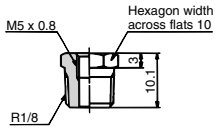

Plug: 10-MS-5P

Weight: 1.2 g

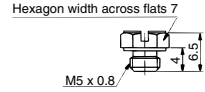

Extension Fitting: 10-MS-5J

Effective area: 4.0 mm²
Weight: 3.4 g

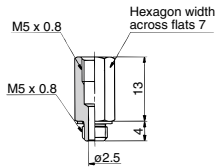

Nipple: 10-MS-5N

Effective area: 4.0 mm²
Weight: 1.4 g

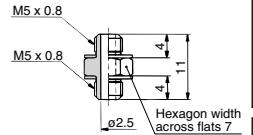

Barb Tee for Polyurethane Tube: 10-MS-5ATHU-3, -4, -6

10-MS-5ATHU-3, -4

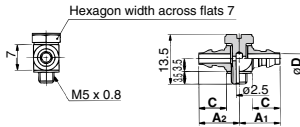

10-MS-5ATHU-6

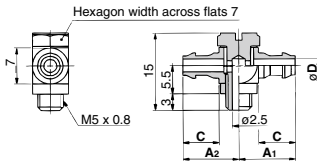

Model	A ₁	A ₂	C	D	Effective area (mm ²)	Weight (g)
10-MS-5ATHU-3	8	8.3	4.5	1.6	1.1	3.4
10-MS-5ATHU-4	8.8	8.8	5.0	1.8	1.4	3.6
10-MS-5ATHU-6	10.8	10.8	7.0	2.5	2.4	4.2

Universal Nipple: 10-MS-5UN

Effective area: 4.0 mm²
Weight: 3.7 g

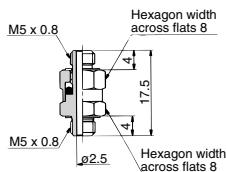

Gasket: 10-M-5G1, 10-M-5GH

Weight: 0.01 g

Weight: 0.04 g



Directional Control Valves
Air Cylinders
Rotary Actuators
Air Grippers
Air Preparation Equipment
Modular F. R.
Pressure Control Equipment
Fittings & Tubing
Flow Control Equipment
Pressure Switches/ Pressure Sensors